

## SFC6000 / SFM6000 Mass Flow Controller / Meter

### Application Note – Fittings

#### WARNING

Most push-in fittings available on the market are not compatible with O<sub>2</sub>-enriched gasses. This includes the fittings supplied with some versions of SFC6000 and SFM6000. For these gasses, please contact Sensirion for alternative fittings, or make sure the fittings you are going to use are compatible with your gas.

## 1 Exchangeable fittings

The fittings of SFC6000 and SFM6000 can be easily modified with a few simple steps:

### 1.1 Remove the old fittings

- 1 Remove both metal rings:
  - i. For the front fitting the metal ring it is to be pulled out from the top.
  - ii. For the rear fitting it must be pulled out from beneath.
- 2 Remove the fittings by pulling them out. You can use any suitable tool as an aid (e.g. sharp tweezers) to help with the removal.



The metal ring for the rear fitting must be accessed from below.

Use an appropriate tool to assist in pulling out the fitting.

### 1.2 Insert the new fittings



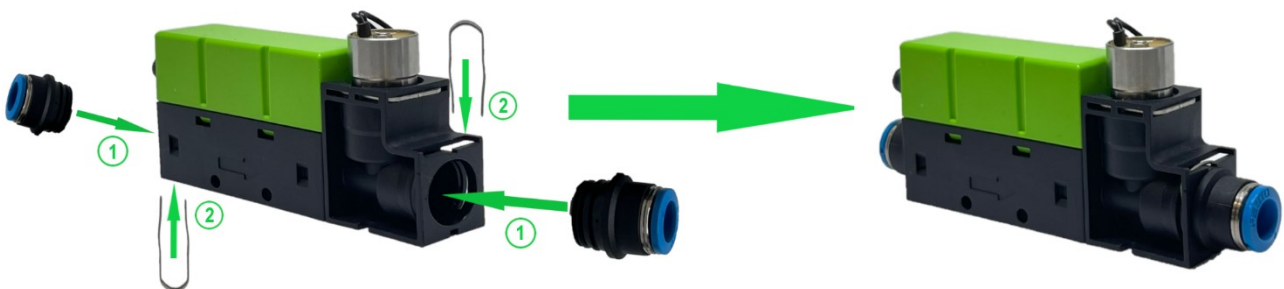





- 1 Insert the new fitting
- 2 Insert the metal rings in the correct manner. From the top for the front fitting and from beneath for the back fitting.



## 2 Compatible fittings

The table below lists fittings compatible with SFC6000 and SFM6000. They can be bought from: <https://www.festo.com/>

Cartridge QSPK18...	
QSPK18-4	
QSPK18-6	
QSPK18-8	
QSPK18-10	
QSPKG18-8	
QSPKG18-10	
Cartridge QSPLK18...	
QSPLK18-4	
QSPLK18-6	

QSPLK18-8	
QSPLK18-10	
QSPLKG18-8	
QSPLKG18-10	
Cartridge QSPLLK18...	
QSPLLK18-4	
QSPLLK18-6	
QSPLLK18-8	
QSPLLK18-10	
QSPLLKG18-8	
QSPLLKG18-10	